

DRAWING MADE BY

LOC AK 86

© 1971 BY AMP
ALL RIGHTS RESERVED
REPRODUCED COPY NOT TO BE
REPRODUCED NOR PUBLISHED
WITHOUT WRITTEN PERMISSION
OF AMP INCORPORATED.

REVISIONS

REV	DESCRIPTION	BY	DATE	INITIALS
0	NPS 70-0616 (REV 1)	WM	2-15-71	FCY
A	REV PER ECN P-6815	JB	4-25-72	Jm
B	.726 WAS .734	JB	4-28-72	Jm
C	REMOVED ENG. CONT NPS 70-0616 (REV 2)	JB	6-21-72	Jm

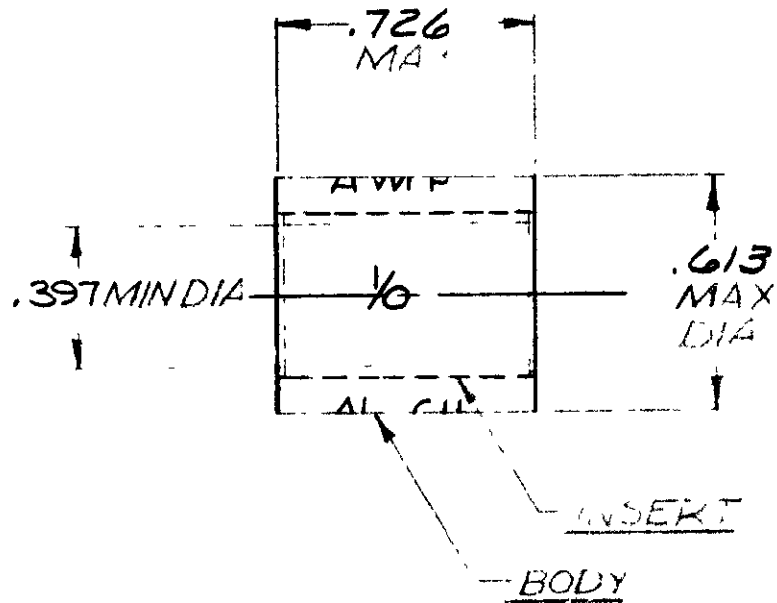

1	WIPE	52749	IN LET: BRASS (MIL-C-50)
QTY	DE	PART NO.	
UNLESS OTHERWISE SPECIFIED ALL DIMENSIONS ARE IN INCHES DECIMALS UNLESS INDICATED OTHERWISE	DATE	BY	AMP
MATERIAL	2-8-71	W. J. ...	
SEE TABLE	2-18-71	K. C. ...	COPALUM PARALLEL-STRANDED/SOLID
	2-18-71	L. W. ...	1/0
		H. ...	52749